

INSTALLATION *guide*



inteo *EOLIS receiver RTS 2*

The EOLIS receiver RTS is a radio receiver for awnings with protection against wind damage.

The EOLIS receiver RTS is compatible with the EOLIS sensor, all the RTS controls and the INIS RT.

Commands are transmitted by radio (frequency 433.42 MHz).

With an INIS RT, the functioning of the EOLIS receiver RTS is a trip switch type :
▲, stop, ▼, stop, ...

1 Characteristics:

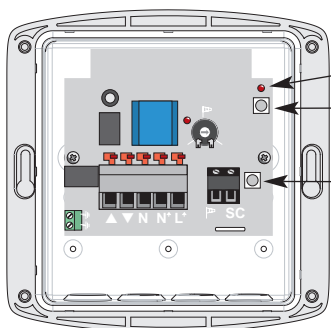

LED
Programming button
Built-in manual security control

- Mains supply : 220-240 V~ 50/60 Hz
- Protection index: IP 44
- Operating temperature: -20°C to +50°C
- Class II product once installed
- Normally polluted environment

CE Hereby, SOMFY, declares that this equipment is in compliance with the essential requirements and other relevant provisions of Directive 1999/5/EC. A Declaration of Conformity is available at the web address www.somfy.com Heading CE

2 Installation:

Before connecting the unit, you must read the instructions carefully.

A Mounting of the EOLIS receiver RTS 2 :

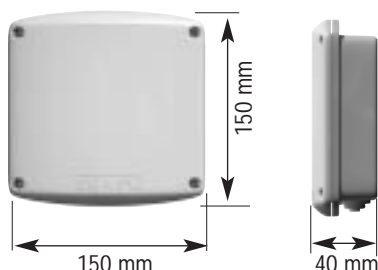

Recommendations :

- Install the EOLIS receiver RTS with the cables entry pointing downwards to avoid water infiltration.
- Do not install the EOLIS receiver RTS against a metallic part (it could affect the radio transmission).
- minimum distance between the receiver and the floor : **1,5 m**.
- minimum distance between the receiver and the roof : **30 cm**.
- minimum distance between the receiver and the transmitter : **30 cm**.
- minimum distance between two receivers : **20 cm**.

B Cabling of the EOLIS receiver RTS 2 :

The EOLIS receiver RTS is compatible with all standard SOMFY motors. Cabling arrangements are shown in the diagram. Respect the electrical standards in force as well as the following points:

- disconnect the mains before carrying out any work.
- be careful to avoid static electricity which could damage some electronic components.
- use flexible cables
- ensure that no longitudinal forces act on the cable carriers after installation
- **do not forget to connect the earth wires.**

Cabling of the EOLIS sensor

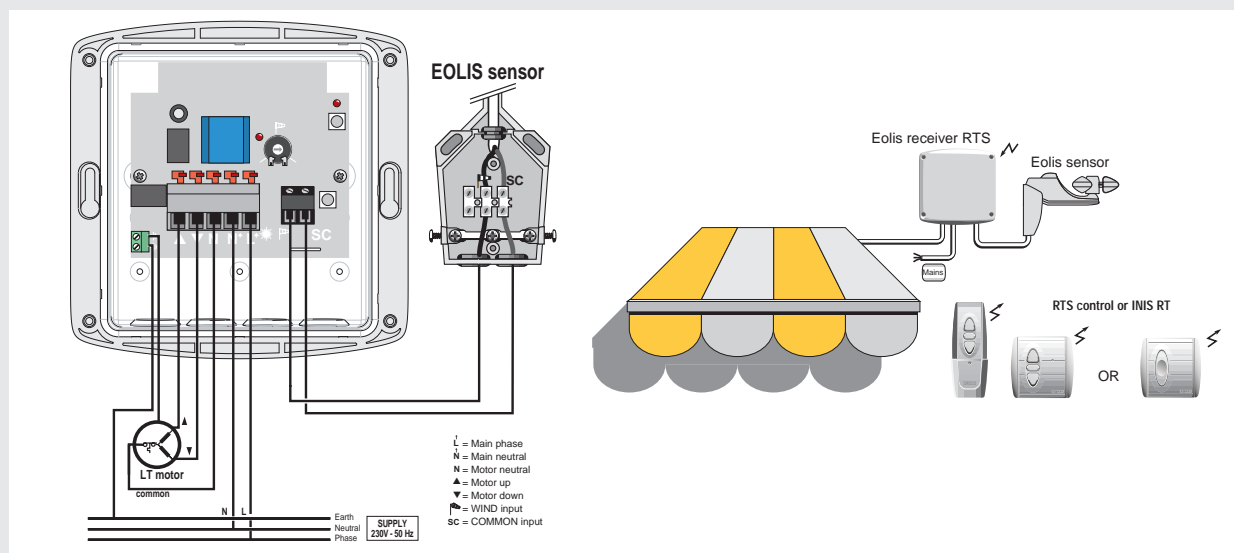

WARNING : if the awning moves DOWN when pressing the UP button of the RTS control, invert the brown and black motor wires.

Cabling / fixing of the EOLIS sensor

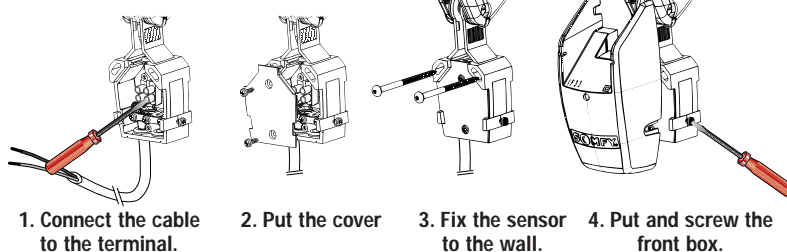

Mounting of the EOLIS sensor

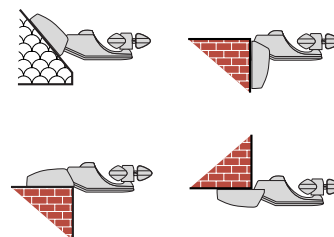

C Wind function :

The EOLIS receiver RTS is able to protect awnings against wind damage using EOLIS sensor

The wind threshold can be adjusted by the potentiometer to accommodate wind speeds between 10 to 50 Km/h.

Principle :

When the wind speed exceeds the threshold set by the EOLIS receiver RTS, after 2 seconds, an UP order is given to the motor.

As long as the measured wind speed is higher than the adjusted threshold, any order from the RTS control is inhibited.

When the wind speed falls below the threshold setting, a time delay of 30 seconds is activated.

After this time delay any order can be given with the RTS control.

“S” jumper :

When the jumper is cut, if a down control has been given just before the wind appearance, the EOLIS receiver RTS will automatically send a down control to the motor after 12 minutes.

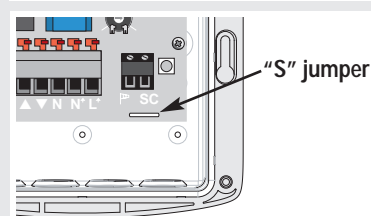
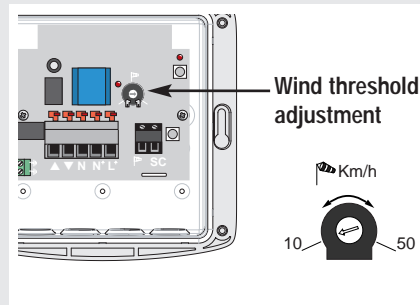

D Programming :

1 INITIAL INSTALLATION

with an RTS control (TELIS soliris RTS ; Centralis RTS ; TELIS 1 or 4 RTS).

Set the EOLIS receiver RTS in its programming mode by pressing the PROG button until the LED lights.

This indicates that the SOLIRIS receiver RTS is ready to receive the address of a control for one minute (After this time limit, the LED will go out).

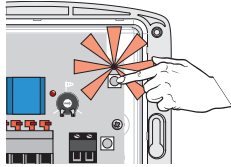

Press **shortly** the programming button on the RTS control.



The LED of the EOLIS receiver RTS blinks indicating that the address of the RTS control is memorized in receiver which automatically quits its programming mode.

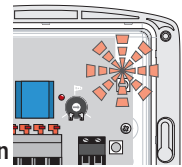

with an INIS RT.

Set the EOLIS receiver RTS in its programming mode by pressing the PROG button until the LED lights.

This indicates that the EOLIS receiver RTS is ready to receive the address of a control for one minute (After this time limit, the LED will go out).

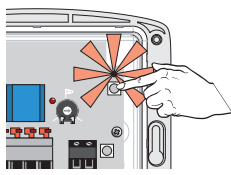

1. remove the battery

2. press **shortly** the push button

3. replace the battery

4. press **shortly** the push button

The LED of the EOLIS receiver RTS blinks indicating that the address of the INIS RT is memorized in receiver which automatically quits its programming mode.

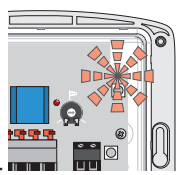

MULTIPLE CONTROL

• Assign several controls to the EOLIS receiver RTS following the same procedure as described above. You can assign up to 12 controls to one receiver. If you try to enter a 13th, your instruction will be ignored, the led of the receiver will go out.

GENERAL OR GROUP CONTROL

• Set all the EOLIS receiver RTS you wish to control by one control in their programming mode and record the control following the same procedure as described above.
⇒ The LEDs of all the EOLIS receiver RTS blink indicating that the address of the control is memorized in all these receivers.

2 ADD A NEW CONTROL IN THE MEMORY OF A RECEIVER (ON AN EXISTING INSTALLATION)

• To add a new control in the memory of a RTS receiver, set the EOLIS receiver RTS in its programming mode (see § D1), then press shortly the prog button of the RTS control you wish to add (to add an INIS RT, remove/replace the battery then press the front button).

• It is also possible to “wake up” the EOLIS receiver RTS with another control.

From a RTS control : press for more than 2 seconds on the prog button of the RTS control, then press shortly the prog button of the RTS control you wish to add (to add an INIS RT, remove/replace the battery then press the front button).

From a RT control : remove/replace the battery and press the front button of the INIS RT, then press shortly the prog button of the RTS control you wish to add (to add another INIS RT, remove/replace the battery then press the front button).

3 REMOVE A RTS CONTROL FROM THE MEMORY OF THE RECEIVER (ON AN EXISTING INSTALLATION)

• To remove a RTS control from the memory of a RTS receiver, set the EOLIS receiver RTS in its programming mode (see § D1), then press shortly the prog button of the RTS control you wish to remove (to remove an INIS RT, remove/replace the battery then press the front button).

• It is also possible to “wake up” the EOLIS receiver RTS with another control (see § D2), then press shortly the prog button of the RTS control you wish to remove (to remove an INIS RT, remove/replace the battery then press the front button).

4 REMOVE ALL THE CONTROLS FROM THE MEMORY OF THE RECEIVER (RESET OF THE EOLIS RECEIVER RTS)

• To remove the addresses of all the controls from the memory of a EOLIS receiver RTS, press the programming button of the EOLIS receiver RTS until the LED **blinks**.

⇒ The memory of the receiver is erased.

E Intermediate position (WITH A RTS CONTROL ONLY)

With the EOLIS receiver RTS and a RTS control, it is possible to set one or two intermediate positions (IP) : one accessible from the top of the awning (IP1) and one from the bottom (IP2).

To record these positions, the EOLIS receiver RTS has to record the time for the awning to go from its top to the IP and also the time from its bottom one to the IP.

RECORD THE INTERMEDIATE POSITION FROM THE TOP OF THE AWNING

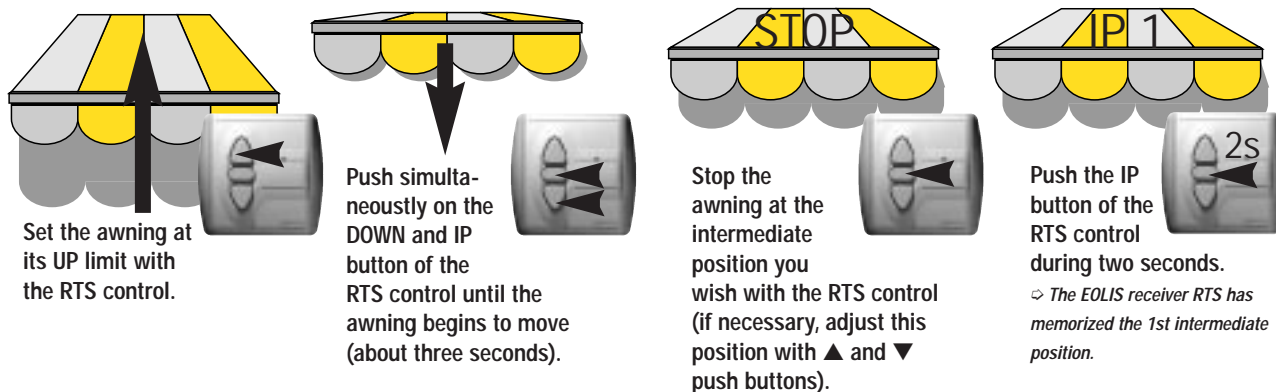

RECORD THE INTERMEDIATE POSITION FROM THE BOTTOM OF THE AWNING

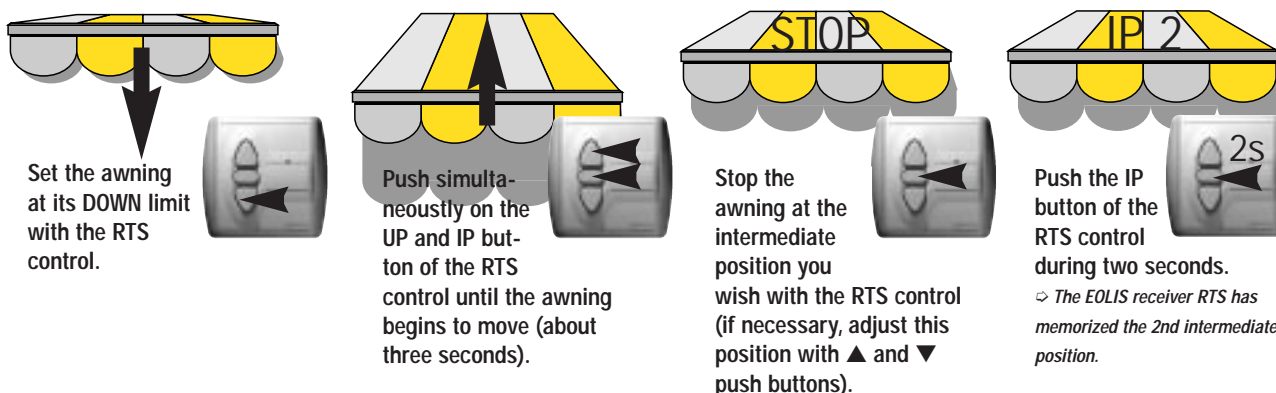

REACH THE INTERMEDIATE POSITIONS

To reach one of the intermediate positions, set the awning is at its UP (for IP1) or DOWN (for IP2) limit, then press briefly the IP button of the RTS control.

⇨ The awning will move and stop at the dedicated intermediate position.

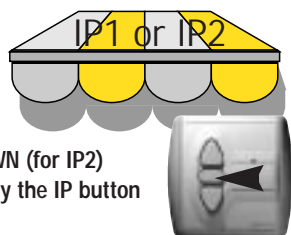

DELETE AN INTERMEDIATE POSITION

To delete an intermediate position, press briefly the IP button of the RTS control to reach the intermediate position you wish to delete, then press continuously the IP button of the control until the led stops blinking (approx. 8 sec.).

⇨ The concerned IP is deleted.

Diagnosis

The LED on the RTS control does not light.

Check the battery of the RTS control.

The led of the RTS control lights, but the motor does not operate.

- 1- Press the built-in manual security control of the EOLIS receiver RTS.
- 2- Check the programming.
- 3- Check the good wiring of the motor and the EOLIS receiver RTS.