

INSTALLATION *guide*



inteo *EOLIS box 2*

The **EOLIS box** is an individual control for awnings from one or several double push buttons with protection against wind damage. The **EOLIS box** is compatible with the **EOLIS sensor**.

1 Characteristics:

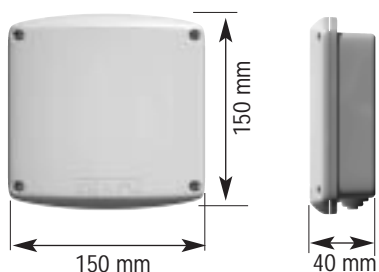

- Mains supply
 - 230V version : 220-240 V~ 50/60 Hz
 - 120V version : 100-120 V~ 50/60 Hz
- Protection index: IP 44
- Operating temperature: -20°C to +50°C
- Class II product once installed
- Normally polluted environment

2 Installation:

Before connecting the unit, you must read the instructions carefully.

A Cabling of the EOLIS box 2 :

The EOLIS box is compatible with all standard SOMFY motors. Cabling arrangements are shown in the diagram.

Respect the electrical standards in force as well as the following points:

- disconnect the mains before carrying out any work.
- be careful to avoid static electricity which could damage some electronic components.
- use flexible cables
- ensure that no longitudinal forces act on the cable carriers after installation
- Install the EOLIS box with the cable entry pointing downwards to avoid water infiltration.
- **do not forget to connect the earth wires.**

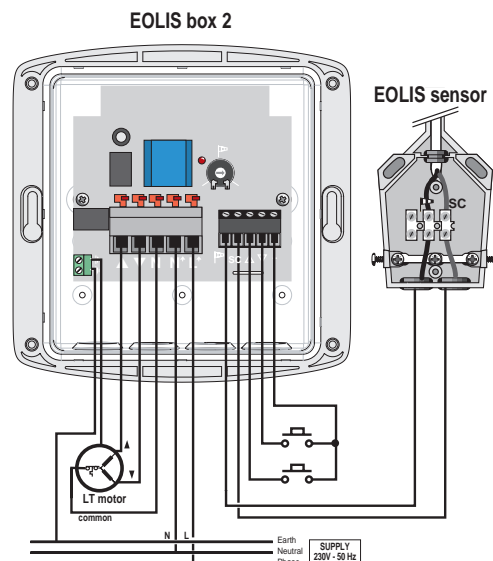

Wiring principle of the Eolis box 2

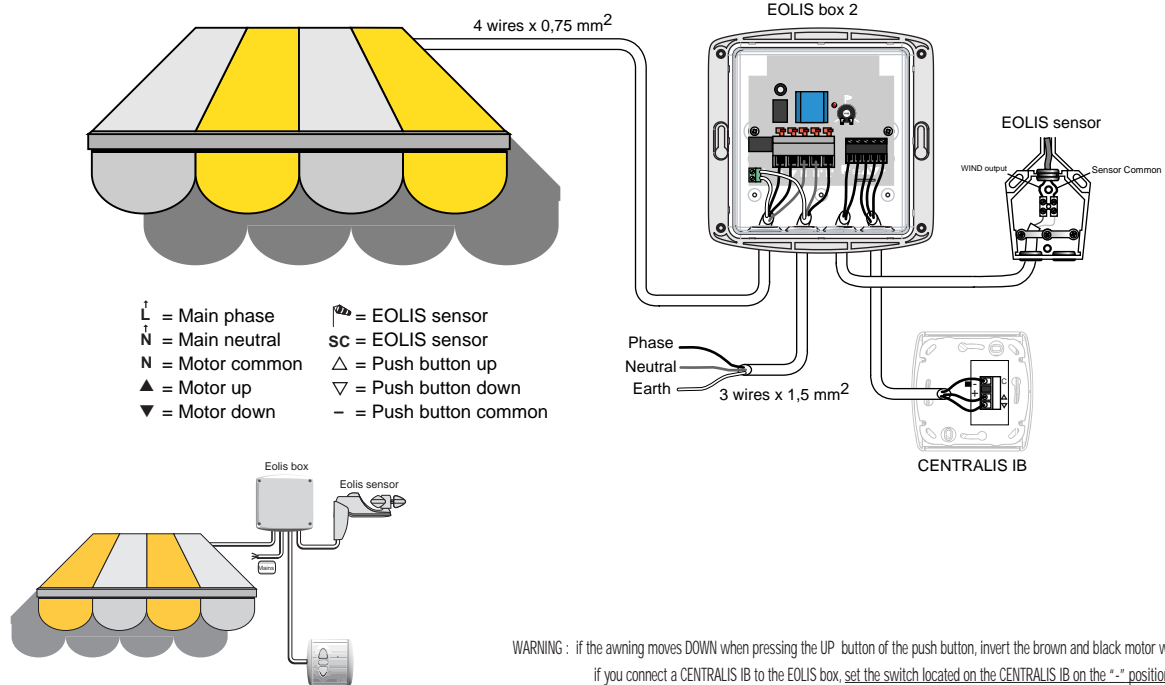

Cabling / fixing of the EOLIS sensor

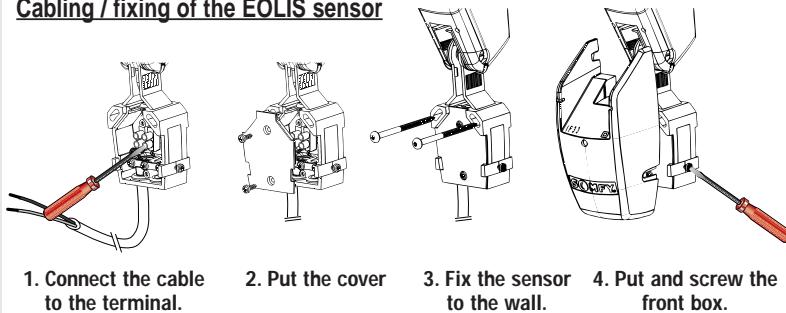

Mounting of the EOLIS sensor

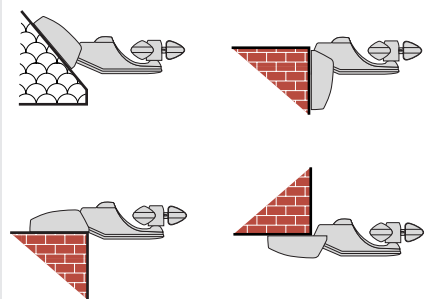

B Wind function :

The EOLIS box is able to protect awnings against wind damage using Eolis sensor

The wind threshold can be adjusted by the potentiometer to accommodate wind speeds between 10 to 50 Km/h.

Principle :

When the wind speed exceeds the threshold set by the EOLIS box, after 2 seconds, an UP order is given to the motor.

As long as the measured wind speed is higher than the adjusted threshold, any order from the push button is inhibited.

When the wind speed falls below the threshold setting, a time delay of 30 seconds is activated.

After this time delay any order can be given with the push button.

"S" jumper :

When the jumper is cut, if a down control has been given just before the wind appearance, the EOLIS box will automatically send a down control to the motor after 12 minutes.

